

Architectural / Engineering Services

for

*New Police Headquarters
Stamford Police Department*

RFQ #671

March 12, 2015



QUALIFICATIONS STATEMENT

RFQ No. 671
ARCHITECTURAL / ENGINEERING SERVICES
for
NEW POLICE HEADQUARTERS
STAMFORD POLICE DEPARTMENT, STAMFORD, CT

INDEX **TAB**

SECTION 1: COVER LETTER **1**

COVER LETTER

STATEMENT OF QUALIFICATIONS

- PROVEN EXPERIENCE, POLICE FACILITY DESIGN
- AVAILABILITY OF STAFF TO PROJECT SITE
- SUBCONSULTANTS' EXPERIENCE AND AVAILABILITY

SECTION 2: TECHNICAL RESPONSE **2**

PREVIOUS PROJECT EXPERIENCE

- FIRM PROFILE
- POLICE FACILITY PLANNING & DESIGN EXPERIENCE (LAST 5 YEARS)
- RESUME – BRIAN W. HUMES, AIA, PRINCIPAL-IN-CHARGE
CURRENT LICENSE TO PRACTICE IN CT – BRIAN W. HUMES, AIA
IACP POLICE FACILITY TRAINING CERTIFICATE
- RESUME – MARK ALLEN, PROJECT ARCHITECT
IACP POLICE FACILITY TRAINING CERTIFICATE
- RESUME – KEVIN LIPE, AIA, SCHEMATIC DESIGNER
- RESUME – MICHELLE LANNEY, RENDERER
- RESUME – MICHAEL RINALDI, INTERIOR DESIGN COORDINATOR
- PAST PERFORMANCE ON SIMILAR PROJECTS – BUDGET SUMMARY
- LEED EXPERIENCE / SUSTAINABLE CONSTRUCTION

DESIGN TEAM QUALIFICATIONS / EXPERIENCE

- ORGANIZATIONAL CHART
- KOHLER RONAN CONSULTING ENGINEERS, DANBURY, CT
- REDNISS & MEAD CONSULTING ENGINEERS, STAMFORD, CT
- BVH STRUCTURAL ENGINEERS, BLOOMFIELD, CT
- BETA GROUP, HARTFORD, CT
- CAMA INCORPORATED, NEW HAVEN, CT
- KVASOCIATES, BOSTON, MA
- WELTI ASSOCIATES, GLASTONBURY, CT
- MYSTIC AIR QUALITY CONSULTANTS, LEDYARD, CT

SECTION 3: REFERENCES

3

REPUTATION / PROFESSIONAL REFERENCES

- PROFESSIONAL REFERENCES
- LETTERS OF RECOMMENDATION

SECTION 4: PROPOSAL RESPONSE / SUMMARY

4

PROPOSAL RESPONSE / SUMMARY

- PROJECT SCOPE
- PROJECT MANAGEMENT
- PROJECT STAFF
- EXPERIENCE AND CAPABILITIES
- INTEREST IN THE PROJECT
- LITIGATION HISTORY

END OF INDEX

Cover Letter

1

March 12, 2015

Ms. Beverly Aveni, Purchasing Agent
City of Stamford
Purchasing Department
888 Washington Boulevard
Stamford, CT 06901

Attn: RFQ No. 671
Architectural/Engineering Services
Stamford Police Headquarters

Dear Selection Committee:

It is with great pleasure and anticipation that I introduce **Jacunski Humes Architects, LLC, 15 Massirio Drive, Suite 101, Berlin, CT**, for your consideration with regard to your Request for Qualifications #671 for a new Police Headquarters for the City of Stamford, CT.

Jacunski Humes Architects, LLC has more active police facility design projects than any other architectural firm throughout New England. The design of a police facility is unlike any other project and demands current, relevant experience to produce a suitable and safe solution. For the past thirty (30) years, I have dedicated my architectural career, knowledge, and expertise to the area of Police Facility Planning and Design. Through this involvement with the law enforcement community, I have personally been involved with the space planning, needs assessments, design, or construction of *over EIGHTY (80)* police facilities throughout six (6) states and have established a ***national reputation*** in the field of Police Facility Planning and Design. I have been a regular contributor to *Police Chief* magazine, and have conducted seminars on Police Facility Design and Building Security Infrastructure. In addition, I have maintained membership and regularly attended the conferences of the International Association of Chiefs of Police (IACP), the New England Association of Chiefs of Police, Inc. (NEACP), Massachusetts Police Chiefs Association (MPCA), and the Connecticut Police Chiefs Association (CPCA).

What I have to offer your project is a hands-on, personal approach that will address the scope of work outlined within your Request for Qualifications (RFQ). I have been faced with similar conditions and have met and exceeded their goals for professional services with the utmost of client satisfaction.

To assist us with our efforts for this new Police Headquarters, **Jacunski Humes Architects, LLC** is planning to utilize relevant and experienced consultants that are familiar with working with my firm, experienced in police facility design, familiar with LEED certification requirements, and have a track record of on-time, on-budget, performance with quality project documentation.

The following consultants are being proposed:

Mechanical / Electrical / Plumbing / Fire Protection Engineers:

Kohler Ronan LLC, Consulting Engineers, Danbury, CT

Security / IT Infrastructure Engineers:

Kohler Ronan LLC, Consulting Engineers, Danbury, CT

Site / Civil Engineers:

Redniss & Mead Inc, Stamford, CT

Traffic Engineers / Landscape Architects:

BETA Group, Hartford, CT

Structural Engineers:

BVH Integrated Services, Bloomfield, CT

Interior Designers:

CAMA Incorporated, New Haven, CT

Geotechnical Engineers:

Clarence Welti, P.C., P.E., Glastonbury, CT

Environmental Engineers:

Mystic Air Quality Consultants, Ledyard, CT

Professional Cost Estimating:

KVAssociates Inc., Boston, MA

Recently completed Public Safety Facility Designs that have been completed by **Jacunski Humes Architects, LLC** and the Design Team indicated above include:

Darien Police Headquarters, Addition and Renovations, Darien, CT

JHA / Kohler Ronan / KVA

Danbury Police Headquarters, New Construction, Danbury, CT

JHA / Kohler Ronan / BVH / KVA

East Hartford Public Safety Complex, Addition and Renovation, East Hartford, CT

JHA / BVH / KVA / Mystic Air / Welti

Westborough Fire Headquarters, New Construction, Westborough, MA

JHA / BVH / Mystic Air / Welti

WCSU Police Headquarters, New Construction, Danbury, CT (in design)

JHA / Kohler Ronan / Welti

UCONN Public Safety Facility, New Construction / Renovations, Storrs, CT

JHA / BVH / KVA

For **Jacunski Humes Architects, LLC**, the portfolio of Police and Public Safety Facility design and construction experience within the last five (5) years represents in excess of \$155,000,000 in construction value!!

As a Partner of **Jacunski Humes Architects, LLC**, I have maintained a continuous CT license in architecture since 1988. I will be personally responsible for all aspects of this project from beginning to end. I am familiar with the tasks which must be performed to ensure a safe and secure police facility that will be designed to accommodate all of the latest standards for safety and technology.

I trust that a thorough review of this qualification package will outline my prior experience in this very technical building type, my enthusiasm to produce a quality product for the City of Stamford, and the qualifications of my design team which meets and exceeds your requirements. I am available at your convenience to discuss any aspects of this submission. I trust that I will have an opportunity to present my firm, and design team, to you at a personal interview and thank you in advance for that opportunity.

Very Truly Yours,

Brian W. Humes, AIA, LEED AP
Jacunski Humes Architects, LLC

Addendum Acknowledgement:

- This proposal acknowledges receipt of **Addendum No. 1**, dated February 9, 2015

Supplemental Information:

1. Name and address of Proposer:
Jacunski Humes Architects, LLC, 15 Massirio Drive, Suite 101, Berlin, CT 06037
2. Individual within the firm who is authorized to commit the company to this contract:
Brian W. Humes, AIA, LEED AP, Member, (860) 828-9221
3. Name, title, and telephone number of the individual whom the Office of Operations should contact regarding questions, and clarifications:
Brian W. Humes, AIA, LEED AP, Member, (860) 828-9221
4. The Corporation name and address of all proposed subcontractors, consultants, or partners:
Kohler Ronan, LLC., 93 Lake Avenue, Danbury, CT. 06810
Redniss & Mead, Inc., 22 First Street, Stamford, CT. 06905
BETA Group., 1010 Wethersfield Ave, Suite 305, Hartford, CT 06114
BVH Integrated Services, 50 Griffin Road South, Bloomfield, CT. 06002
CAMA, Inc., 31 Audubon Street, New Haven, CT. 06511
Clarence Welti Associates, Inc., 227 Williams Street East, Glastonbury, CT 06033
Mystic Air Quality Consultants, Inc., 1204 North Road, Groton, CT. 06340
KV Associates, Inc., 303 Congress Street, Boston, MA. 02210

5. Time for validity of fee proposal:
One Hundred and Twenty (120) Days from the due date of the proposal.
6. Statement:
Brian W. Humes has been licensed to practice Architecture within the State of Connecticut continuously since 1988.

bwhproposals.stamford.policeheadquarters.letterofinterest

PROVEN EXPERIENCE ! **POLICE FACILITY DESIGN:**

Connecticut:

- Wilton Police Department
- Old Saybrook Police Department
- Weston Police Department
- Ledyard Police Department
- Milford Police Department
- Norwich Police Department
- Woodbridge Police Department
- Milford Police Department
- Trumbull Police Department
- Groton Town Police Department
- Berlin Police Department
- Newtown Police Department
- Wallingford Police Department
- New Canaan Police Department
- Darien Police Department
- Bethel Police Department
- Danbury Police Department
- Glastonbury Police Department
- Redding Police Department
- Hartford Police Department
- New Haven Police Department
- East Lyme Police Department
- Western CT State University Police
- Windsor Police Department
- Monroe Police Department
- Central CT State University Police
- East Hartford Police Department
- Newington Police Department
- State of Connecticut, DEP, Law Enforcement Division
- Eastern CT State University Police
- Simsbury Police Department
- New Britain Police Department
- Plainville Police Department
- Winsted / Winchester Police Department
- Wethersfield Police Department
- Canton Police Department
- West Haven Police Department
- Cromwell Police Department
- Waterbury Police Department
- Farmington Police Department
- Clinton Police Department
- Granby Police Department
- Orange Department of Police Service
- Stonington Police Department

PROVEN EXPERIENCE ! **POLICE FACILITY DESIGN:**

Massachusetts:

- Orleans Police Department
- Barre Police Department
- Metacomet Emergency Communications Center (MECC)
- Brookfield Police Department
- Millbury Public Safety Complex
- Winchendon Police Department
- Northfield Police and Fire Departments
- Norwell Police Department
- Montague Police Department
- Westborough Police Department
- Chatham Police Department
- Dennis Police Department
- Watertown Police Department
- Massachusetts State Police Logan Airport Troop F
- Bernardston Police Department
- Acton Police Department
- Marion Police Department
- Waltham Police Department
- Bolton Police Department
- Great Barrington Department
- West Newbury Police Department
- Athol Police Department
- Wayland Police Department
- Sherborn Police Department
- Rockport Police Department
- Norwood Police Department
- Longmeadow Police Department
- Leominster Police Department
- Rockland Police Department
- Holland Police Department
- Ayer Police Department

Rhode Island:

- Charlestown Police Department
- Scituate Police Department

Pennsylvania:

- Scranton Police Department

Vermont:

- South Burlington Police Department

Availability of Staff to Project Site

Jacunski Humes Architects, LLC maintains architectural staff that is able to work from an office within the area that would allow the assigned professionals to be available on a full time basis.

Jacunski Humes Architects, LLC Project Team:

Brian W. Humes, AIA, Partner-in-Charge

30 years experience in Public Safety Design, 27 years as Registered Architect

Mark Allen, Project Architect

14 years experience in Public Safety Design, 24 years as Registered Architect

Kevin W. Lipe, AIA, Schematic Design

17 years experience in Public Safety Design, 24 years as Registered Architect

Michael Rinaldi, Interior Design and Furniture, Fixtures and Equipment

10 years experience in Public Safety Interior Design

Michelle Lanney, Rendering and Graphics

3 years experience in Public Safety Rendering and Presentation

In the last five (5) years, this project team has completed the following police facilities:

- Western Connecticut State University Police Facility, Danbury CT
anticipated construction completion 2016.
9,646 sf new construction, High Performance Building Standards
- Gardner, MA Police Department, completed March, 2015
Extensive site remediation, 30,000 sf new construction, 2,500 sf prefabricated storage building and 11-car parking canopy.
- Monroe, CT Police Department, completed October, 2013
5,185 sf new construction, 17,175sf renovation
- Darien, CT Police Department, completed January 2012
28,735 sf new construction, 13,234sf renovation, phased construction.
- Danbury, CT Police Department, completed January 2010
Extensive site remediation, 74,839 sf new construction

Subconsultants' Experience and Availability

Jacunski Humes Architects, LLC utilizes an experienced and knowledgeable team of consultants tailored to fit your project needs.

Jacunski Humes Architects, LLC Project Team Consultants:

Kohler Ronan, LLC, M/E/P/FP Engineers with 17 years experience

Redniss & Mead, Inc., Site/Civil Engineers with 58 years experience, 35 full time employees and 14 professional employees.

BETA, Inc., Traffic Engineers and Landscape Architects with 33 years experience, 130 employees.

BVH Integrated Services, Structural Engineers with 57 years experience.

CAMA, Inc., 31 Audubon Street, Interior Designers with 32 years experience

Clarence Welti Associates, Inc., Geotechnical Engineers with 47 years experience

Mystic Air Quality Consultants, Inc., Environmental Engineers with 28 years experience

KV Associates, Inc., Professional Cost Estimators with 25 years experience

All Sub-Consultants maintain businesses that are within the area that would allow the assigned professionals to be available on a full time basis.

Technical Response

2

Firm Profile

Jacunski Humes Architects, LLC

Specializing in Police Facility Design

Jacunski Humes Architects, LLC is located in Berlin, Connecticut. We are a full-service architectural firm with a total staff of ten (10). Of those ten, five (5) are licensed to practice architecture in the State of Connecticut.

To assist in our design efforts, we hand pick experienced and qualified engineering consultants to assist in our efforts. These consultants are familiar with our firm, highly skilled in police facility design requirements, familiar with code implications of our designs, and share the same commitment to client satisfaction.

Brian W. Humes, AIA, LEED AP is a Founding Partner in the firm and brings with him over thirty (30) years of experience in the design and construction of municipal police, public safety, communication centers, and emergency facilities. The staff of architects employed at Jacunski Humes Architects, LLC has years of experience in municipal police and public safety facility design. The size of the firm will insure a hands-on, principal led effort from beginning to end.

Some of the unique aspects of our firm include:

- ◆ Extensive knowledge of Police Facilities and their functional requirements
- ◆ Registered Architect, NCARB Certified, LEED Certification
- ◆ Experience in both new construction and renovated facilities
- ◆ Conducted Seminars on Police Facility and Security Design
- ◆ Member: International Chiefs of Police, New England Chiefs of Police Association, Massachusetts Police Chiefs Association, and Connecticut Police Chiefs Association
- ◆ Established national network of consultants to deal with technical aspects of police, public safety, communications centers, and emergency facility design

POLICE FACILITY PLANNING & DESIGN EXPERIENCE

THE FOLLOWING IS LISTED IN CHRONOLOGICAL ORDER:

Last 5 years (2010-2015)

Barre Public Safety Facility, Barre, MA

2015

Providing architectural / engineering services for the construction of a new public safety facility for the Town of Barre, MA. Anticipated project cost of \$3.0M.

Contact: Mr. Erik Demetropoulos, Chief of Police
Barre Police Department
Barre, MA
(978) 355-4991

Metacomet Emergency Communications Center (MECC), Sharon, MA

2015

Providing architectural / engineering services for the construction of a new regional emergency communications center to service the Towns of Wrentham, Sharon, Franklin, and Norfolk, MA. Anticipated project cost of \$3.0M.

Contact: Mr. William Ketcham, Town Administrator
Town of Wrentham, MA
WKetcham@wrentham.ma.us

Orleans Police Department, Orleans, MA

2015

Providing architectural peer review services to evaluate the merit of a 2008 study for a new police facility for the Orleans Police Department, Orleans, MA. Anticipated size: 17,738 s.f. Anticipated project cost of \$10.25M.

Contact: Mr. Ron Collins, Buildings and Facilities Manager
Town of Orleans, MA
(508) 240-3700 ext. 354

continued:

Trumbull Police Department, Trumbull, CT

2014

Providing architectural / engineering services for the renovation of Dispatch Communications Center for the Trumbull Police Department, Trumbull, CT. Anticipated project cost of \$1.6M.

Contact: Mr. Glenn Byrnes, Deputy Chief of Police
Trumbull Police Department
Trumbull, CT
(203)-261-3665

Brookfield Police Department, Brookfield, MA

2014

Providing architectural / engineering services for the construction of a new police facility for the Town of Brookfield, MA. Anticipated size: 4,500 s.f. Anticipated project cost of \$1.1M.

Contact: Mr. Michael Blanchard, Chief of Police
Brookfield Police Department
Brookfield, MA
(508) 867-5570

Bethel Police Department, Bethel, CT

2014

After ten (10) year delay, assisted the Town of Bethel, CT and their Municipal Building Committee to update their Space Needs Assessment, Site Evaluation, Schematic Design, and professional cost estimates in anticipation of funding authorization request for late 2014.

Contact: Mr. Jon Menti, Chair, Municipal Building Committee
Town of Bethel, CT
jmenti30@att.net

Wilton Police Department, Wilton, CT

2013

Conducting Space Needs Assessment to determine the current and future needs of the Wilton Police Department.

Contact: Mr. Michael Lombardo, Chief of Police
Wilton Police Department
Wilton, CT
(203) 834-6260

continued:

Millbury Public Safety Facility, Millbury, MA

2013

Conducting Space Needs Assessment, site evaluation, schematic design, and professional cost estimating services to determine the current and future needs of a new Public Safety Facility for the Town of Millbury, MA. Anticipated project costs: \$17M.

Contact: Ms. Jayne Marie Davolio, Town Clerk, Chair of Building Committee
Town of Millbury, MA
(508) 865-9110

Old Saybrook Police Department, Old Saybrook, CT

2013

Providing architectural / engineering services for the renovation / addition to an existing building to provide for the needs of the Department of Police Services, Old Saybrook, CT. Anticipated size: 23,000 s.f. Anticipated project cost of \$10.6M.

Contact: Mr. Michael A. Spera, Chief of Police
Department of Police Services
Old Saybrook, CT
(860)-395-3142

Weston Police Facility, Weston, CT

2013

Conducting Space Needs Assessment, site evaluation, schematic design, and professional cost estimating services to determine the current and future needs of the Weston Police Department. Anticipated size: 14,300 s.f. Anticipated project cost \$7.15M.

Contact: Mr. John Troxell, Chief of Police
Weston Police Department
Weston, CT
(203)-222-2667

UConn Public Safety Facility, Storrs, CT

2013

Providing Architectural / Engineering services for Public Safety Facilities Analysis and Master Plan for the University of Connecticut. Anticipated size: 90,550 s.f. Project cost estimate: \$35-40M.

Contact: Ms. Barbara R. O'Connor, Director of Public Safety / Chief of Police
UConn, Division of Public Safety
(860)-486-4806

continued:

Monroe Police Department, Monroe, CT

2013

Provided architectural / engineering services for construction of a new 5,510 s.f. addition and 14,330 s.f. renovation of the Monroe Town Hall for use by the Monroe Police Department. Construction and sitework: \$3.095M. Completion and occupancy: September 2013.

Contact: Mr. John Salvatore, Chief of Police
Monroe Police Department
Monroe, CT 06468-1800
(203)-261-3622

Norwich Police Department, Norwich, CT

2013

Conducted Space Needs Assessment and Site Needs Assessment to determine the current and future needs of the Norwich Police Facility. Scope of work includes site evaluations and schematic design documents to further identify a new Police Department and Civil Preparedness Facility for a new site location within Norwich, CT. Anticipated project cost estimate of \$23M.

Contact: Mr. Louis J. Fusaro, Chief of Police
Norwich Police Department
Norwich, CT 06360
(860)-886-5561

Darien Police Department, Darien, CT

2012

Provided architectural / engineering services for the addition and renovation of the Darien Police Department utilizing their existing site. Building area: 36,654 s.f. total (23,335 s.f. new construction, 13,319 s.f. renovation of existing).
Project cost \$17,629,000 (total project), \$14,747,394 (construction and sitework)

Contact: Mr. Duane Lovello, Chief of Police
Darien Police Department
Darien, CT 06820
(203)-662-5300

Ledyard Police Facility, Ledyard, CT

2012

Providing architectural / engineering services for the construction of an anticipated 12,380 s.f. new Police Department. Project cost estimate of \$5.028M.

Contact: Mr. John Rodolico, Mayor
Town of Ledyard, CT
Email: mayor@ledyardct.org

continued:

Western Connecticut State University Police, Danbury, CT

2012

Providing architectural / engineering services for new University Police Department on Midtown Campus. Anticipated size: 8,500sf. Anticipated construction cost of \$4.75M. Project designed to LEED Silver, High Performance Building Standards.

Contact: Mr. Roger Connor, Lieutenant
WCSU Police
Western Connecticut State University
Danbury, CT 06810
(203)-837-9300

Gardner Police Department, Gardner, MA

2012

Providing architectural / engineering services for the construction of a new +/-30,000 sq. ft., two story, building for the Gardner Police Department and a new +/- 2,000 sq. ft, Storage Outbuilding. Construction and sitework: \$9,393,600. Anticipated completion: Summer 2015.

Contact: Mr. Neil Erickson, Chief of Police
Gardner Police Department
Gardner, MA 01440
(978)-632-5600

Northfield Public Safety Facility, Northfield, MA

2011

Conducted Space Needs Assessment, site evaluation, schematic design, and professional cost estimating to determine the current and future needs of the Northfield Police Department. Fire Department, Emergency Medical, and Emergency Services

Contact: Mr. Jason Platek, Chair, Building Committee
Northfield, MA
Email: jplatek1971@yahoo.com

Norwell Fire / Police Complex, Norwell, MA

2011

Providing architectural / engineering services for the construction of a new +/-11,850 sq. ft., addition onto the Norwell Fire Department for use by the Norwell Police Department to create a new Public Safety Facility. Project also includes a new +/- 1,585 sq. ft, carport structure to provide shelter for official vehicles. Construction and sitework: \$4.798M. Anticipated completion: Spring 2015.

Contact: Mr. Theodore, J. Ross, Chief of Police
Norwell Police Department
Norwell, MA 02061
(781)-659-8161

continued:

Berlin Police Department, Berlin, CT

2011

Conducted schematic design services to determine the best site utilization for a planned new facility for the Berlin Police Department. Projected project cost: \$21M.

Contact: Mr. Paul D. Fitzgerald, Chief of Police
Berlin Police Department
Berlin, CT 06037
(860)-828-7092

Woodbridge Police Department, Woodbridge, CT

2011

Conducted schematic design and professional cost estimating to determine the current and future needs of the Woodbridge Police Department. Projected Project Cost 5.2M

Contact: Mr. Raymond S. Stuart, Deputy Chief of Police
Woodbridge Police Department
Woodbridge, CT 06525
(203)-387-2511, ext. 9

Chatham Police Department, Chatham, MA

2011

Provided Architectural / Engineering services for the construction of a new 18,000 s.f. Police Facility for the Town of Chatham, MA. Project also included Architectural / Engineering services for the construction of a new 20,000 s.f. Town Office Annex. Construction Cost: \$12.94M (2 buildings on 1 site).

Contact: Mr. Mark Pawlina, Chief of Police
Chatham Police Department
Chatham, MA 02633
(508)-945-1217

Cheshire Police Department, Cheshire, CT

2010

Evaluated existing records retention filing systems to determine solutions to improve the filing needs of the Cheshire Police Department.

Contact: Mr. Michael Cruess, Chief of Police, (retired)
Cheshire Police Department
Cheshire, CT 06410
(203)-271-5553

continued:

Milford Police Department, Milford, CT

2010

Conducted Space Needs Assessment, Schematic Design, and professional cost estimating services to determine the current and future needs of the Milford Police Department.

Contact: Mr. Keith Mello, Chief of Police
Milford Police Department
Milford, CT 06460
(203)-783-4800

Marion Police Department, Marion, MA

2010

Provided Architectural / Engineering services for the construction of a new 11,500 s.f. Police Facility for the Town of Marion, MA. Construction Cost: \$2.93 million.

Contact: Mr. Lincoln W. Miller, Chief of Police
Marion Police Department
(508)-748-1212

Bolton Police / Fire Facility, Bolton, MA

2010

Provided Architectural / Engineering services for the construction of a new 11,830 s.f. and renovated 4,795 s.f. combined Fire / EMS and Police Facility for the Town of Bolton, MA. Project cost \$5,900,000 (total project), \$4,311,394 (construction and sitework)

Contact: Mr. Vincent Alfano, Chief of Police
Bolton Police Department
Bolton, MA 01740
(978)-779-2276

Danbury Police Department, Danbury, CT

2010

Provided Architectural / Engineering services for the construction of a new 76,000 s.f. Police Department Facility and elevated parking deck for the City of Danbury, CT. Construction Cost: \$27.9 million. Project Cost: \$33.75 million.

Contact: Mr. Alan Baker, Chief of Police
Danbury Police Department
Danbury, CT 06810
(203)-797-4601

END OF EXPERIENCE – LAST FIVE (5) YEARS

Danbury Police Department

Danbury, CT



"We've only got one shot to do it right!"

Police Chief Alan Baker
(prior to 1,263-335 favorable referendum vote)

- Project:** New Facility for the Danbury Police Department
Danbury, CT
- Size:** +/- 75,000 s.f. new construction (police)
+/- 23,000 s.f. elevated parking deck (public parking)
- Budget:** \$27,942,000 (police facility and sitework), \$33,750,000 (project costs)
- Year:** Funding Approved, May 2006
Construction Start, Spring 2007
Occupied, Summer 2009
- Contact:** Mr. Alan Baker, Chief of Police
Danbury Police Department
(203)-797-4601



Darien Police Department

Darien, CT



"Collaboration was the key to making this work and your diligence in ensuring that every voice was heard, and every concern thought through, left us with a facility design that was nothing short of remarkable."

Duane J. Lovello
Chief of Police

Project: Addition and Renovations to Darien Police Department
Darien, CT

Size: 36,654 s.f. total (23,335 new construction, 13,319 renovation of existing)

Budget: \$17,629,000 (total project), \$14,747,394 (construction and sitework)

Year: Building Occupancy: Fall 2012

Contact: Mr. Duane Lovello, Chief of Police
Darien Police Department
(203)-662-5300



Public Safety Complex

East Hartford, CT



"It's exactly what we need, nothing more"

David J. Dagon, Fire Chief, Retired

Project: Public Safety Complex
East Hartford, CT

Size: +/- 90,000 s.f., additions and renovations to existing Burnside School

Budget: \$27,300,000 (total bonding)

Year: Referendum approved, November 2000
Bidding, Spring 2002
Occupancy, September 2004

Contact: Mr. Timothy D. Larson, Mayor
Town of East Hartford
(860)-291-7200



Norwich Police Department

Norwich, CT



Project: Design / Build Proposal
Norwich Police Department
Norwich, CT

Size: +/- 51,000 s.f. proposed

Budget: \$27,674,235 (total financing cost), \$25,624,235 (construction and sitework)

Year: January 2015

Contact: Mr. Louis Fusaro, Sr., Chief of Police
Norwich Police Department
(860)-886-5561

Public Safety Facility

Westborough, MA



Project: **Public Safety Facility**
 Westborough, MA

Size: +/- 65,000 gross s.f., new construction

Budget: \$24,550,000 (estimated hard costs)

Year: Design funding approved, November 2007
 Project funding approval pending

Contact: Mr. Robert Fryer, Lt.
 Westborough Police Department
 (508)-366-3060

Mr. Calvin Lawrence, Captain
Westborough Fire Department
(508)-366-3040



Public Safety Complex

Norwood, MA



Project: **Public Safety Complex**
 Norwood, MA

Principal Architect: Ganteaume & McMullen, Inc., Architects & Engineers
 Boston, MA

Consulting Architect: Jacunski Humes Architects, LLC
 Space Planning, Floor Plan Design and Detailing, Specification
 Writing

Size: +/- 60,500 s.f., new construction

Budget: \$11,000,000 (construction and sitework)

Year: Competitively Bid, January 2001; Occupied July 2003; Dedication Sept. 2003

Contact:	Mr. Bartley E. King, Chief of Police (retired) Norwood Police Department (781)-762-6888	Mr. William F. Sullivan, Chief (retired) Norwood Fire Department (781)-762-0080
----------	--	--



West Haven Police Department

West Haven, CT



"It's like going from the Flintstones to the Jetsons."

**Mr. Paul Raucci, Sergeant
West Haven Police Department**

Project: West Haven Police Department
West Haven, CT

Size: 48,714.s.f. new construction

Budget: Total project: \$13,000,000, \$8,300,000 (construction and sitework)

Year: Groundbreaking, Spring 2001
Occupancy, March 2004

Contact: Mr. Ronald Quagliani, Chief of Police
West Haven Police Department
(203)-937-3900



Farmington Police Department

Farmington, CT



"Jacunski Humes Architects, LLC should be congratulated on their ability to provide accurate cost data. This project is aesthetically pleasing and has adhered to the budget."

**Bruce Chudwick, Chairman
Building Committee**

Project: Farmington Police Department
Farmington, CT

Size: +/- 26,600 s.f. new construction - police department

Budget: \$9,900,000 (total project), +/- \$6,000,000 (construction and sitework)

Year: Groundbreaking, January 2001
Completed, April 2002

Contact: Mr. Michael J. Whalen, Chief of Police
Farmington Police Department
(860)-675-2450



New Canaan Police Department

New Canaan, CT



Project: Interior Renovations to the New Canaan Police Department
New Canaan, CT

Size: 6,800 s.f. interior renovations

Cost: \$1,215,755 (total construction)

Year: Construction Start: May 2007
Substantial Completion: July 2008

Contact: Mr. Edward J. Nadriczny, Chief of Police
New Canaan Police Department
(203)-594-3513



Gardner Police Department

Gardner, MA



Project: New Facility for the Gardner Police Department
Gardner, MA

Size: 12,250 s.f. new construction

Budget: \$12,000,000 (total project), \$9,500,000 (construction and sitework)

Year: Funding anticipated, November 2011

Contact: Mr. Neil Erickson, Chief of Police
Gardner Police Department
(978)-632-3575

Stonington Police Department

Stonington, CT



"It's the nicest police station I've ever been in. Anyone who's been through here has rated it very highly as well"

David P. Erskine
Chief of Police

Project: Stonington Police Department, Stonington, CT

Size: +/- 27,500 s.f. new construction

Budget: \$6,800,000 (total bonding), \$3,800,000 (construction and sitework)

Year: Dedicated, November 2000

Contact: Mr. David P. Erskine, Chief of Police (retired)
Stonington Police Department
(860)-599-4411



Wethersfield Police Department

Wethersfield, CT



"The firm (of Jacunski Humes Architects, LLC) has experience working on police facilities and has a track record on meeting budgets and deadlines."

Joseph Coombs, Chairman
Police Station Building Committee

Project: Wethersfield Police Department
Wethersfield, CT

Size: +/- 26,500 s.f. new construction

Budget: \$13,000,000 (total bonding), \$4,200,000 (construction and sitework)

Year: Occupancy January 2003

Contact: Mr. James Cetran, Chief of Police
250 Silas Deane Highway
Wethersfield Police Department
(860)-721-2971



Department of Police Services

Old Saybrook, CT



Project: New Police Station for the Department of Police Services
Old Saybrook, CT

Size: 22,624 s.f. total (9,501 new construction; 13,123 interior renovation)

Budget: \$8,625,622 (construction and sitework); Design/Build Project
\$9,995,000 (Total Project)

Year: Groundbreaking: Spring 2014; Anticipated Occupancy: Spring 2015

Contact: Mr. Michael A. Spera, Chief of Police
Department of Police Services
(860)-395-3142

Chatham Police Department & Town Office Annex

Chatham, MA



"A new, modern police facility must be built"

Mark R. Pawlina
Chief of Police

Project: Chatham Police Department & Town Office Annex
Chatham, MA

Size: 42,680 s.f. new construction

Budget: \$15,500,000 (total project), \$11,741,047 (construction and sitework)

Year: Project Completion and Occupancy: May 2011

Contact: Mr. Mark R. Pawlina, Chief of Police
Chatham Police Department
(508)-945-1217

JHI
JACUNSKI HUMES
ARCHITECTS, LLC

BRIAN W. HUMES, AIA, LEED AP

Professional Experience:

Jacunski Humes Architects, LLC

Newington, CT
Founding Partner

May 1996 to Present

Kaestle Boos Associates, Inc.

New Britain, CT
Principal
Associate
Project Manager

June 1994 to January 1996
November 1988 to June 1994
May 1985 to November 1988

Education:

University of Pennsylvania

Philadelphia, Pennsylvania
Master of Architecture

May 1987

Miami University

Oxford, Ohio
Bachelor of Environmental Design

May 1984

Licenses:

Registered Architect:

State of Connecticut
Commonwealth of Massachusetts

1987
1996

NCARB Certified

Certification No. 45924

LEED Accredited Professional
U.S. Green Building Council

2009

continued:

Professional Affiliations:

American Institute of Architects	1988-1991, 1994-Present
International Association of Chiefs of Police	Associate
New England Association of Chiefs of Police	Associate Member
Connecticut Police Chiefs Association	Member
Massachusetts Police Chiefs Association	Associate Member

Citations and Publications:

<u>"Security by Design"</u> AIA CT Training Seminar Presenter	March 2003 and May 2013
--	-------------------------

<u>The Police Chief</u> "Planning and Designing Police Facilities" Contributing Author	March 1995
---	------------

<u>The Police Chief</u> "Combining Public Order With Justice" Co-author	October 1992
--	--------------

Police Security Expo Atlantic City Convention Center Atlantic City, New Jersey Seminar Leader - "Police Facility Design and Planning"	June 1995
---	-----------

IACP Training Seminar Minneapolis, Minnesota "Planning, Design and Construction of Police Facilities"	April 1993
--	------------

Westchester County Chapter, AIA
Citation for Recognition of Architectural Excellence
Police Headquarters and City Court Complex
Mount Vernon, New York

ABC Design Award (Association Builders and Contractors, Inc.) – **Award of Merit**
Farmington Police Department (2003)
Farmington, CT

ABC Design Award (Association Builders and Contractors, Inc.) – **Project of the Year**
Danbury Police Department (2009)
Danbury, CT

STATE OF CONNECTICUT

DEPARTMENT OF CONSUMER PROTECTION

ARCHITECT

BRIAN W HUMES

174 PERCIVAL AVE

KENSINGTON, CT 06037

LIC. / REG NO.

ARI.0004174

EFFECTIVE

08/01/2014

EXPIRES

07/31/2015

SIGNED



The International Association of Chiefs of Police

Certificate of Training

This is to certify that

BRIAN W. HUMES

has successfully completed training in

PLANNING, DESIGN AND CONSTRUCTION OF POLICE FACILITIES

Given this **4TH** *day of* **JUNE** *19* **93**

At

MINNEAPOLIS, MINNESOTA

Daniel N. Rosenblatt

Executive Director
International Association of Chiefs of Police

Marta Brito Perez

Program Manager
International Association of Chiefs of Police

Resume

MARK ALLEN

Project Architect

Full-Time Employee 14 years

Professional Experience:

Jacunski Humes Architects, LLC

Berlin, CT

Project Architect

November 2001 to Present

Friendly Ice Cream Corp.

Wilbraham, MA

Project Architect

May 1991 to October 2001

Kaestle Boos Associates, Inc.

New Britain, CT

Job Captain

May 1987 to January 1991

Education:

Rensselaer Polytechnic Institute

Troy, New York

B.S. Building Sciences

Bachelor of Architecture

May 1986

May 1987

Licenses:

Registered Architect:

State of Connecticut

1991

Commonwealth of Massachusetts

1994

State of New York

1999

NCARB Certified

Certification No. 44151

Training:

IACP Training Seminar

June 2007

Montgomery, Illinois

“Planning, Design and Construction of Police Facilities”

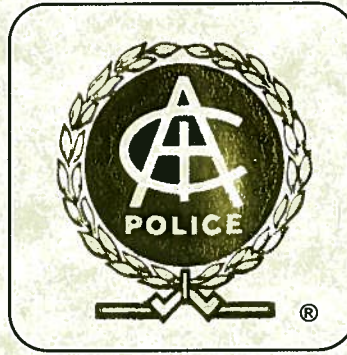

The International Association of Chiefs of Police

Certificate of Training

This is to certify that

Mark Allen

Has successfully completed training in

Planning, Designing and Constructing Police Facilities

June 4-7, 2007

At Montgomery, IL

Daniel N. Rosenblatt

Executive Director
International Association of Chiefs of Police

Charles L. Haynes

Program Manager
International Association of Chiefs of Police

Resume

KEVIN W. LIPE, AIA, LEED AP

Project Architect

Full-Time Employee 17 years

Professional Experience:

Jacunski Humes Architects, LLC

Newington, CT

Senior Project Architect

August 1998 to Present

Plan B Architecture

Tolland, CT

Project Architect

June 1997 to July 1998

Kaestle Boos Associates, Inc.

New Britain, CT

Architect Draftsman

September 1995 to June 1997

Quality By Design

Coventry, CT

Principal

June 1991 to August 1995

The Architects

Glastonbury, CT

Project Manager

March 1987 to June 1991

Education:

University of North Carolina Charlotte

Charlotte, NC

Bachelor of Arts in Architecture

May 1983

Licenses:

Registered Architect:

State of Connecticut

1991

Professional Affiliations:

U.S. Green Building Council,

LEED Accredited Professional

2009-Present

American Institute of Architects

1987-Present

Connecticut Society of Architects

1987-Present

Resume

MICHAEL RINALDI, LEED AP

Design Associate

Full-Time Employee 10 years

Professional Experience:

Jacunski Humes Architects, LLC

Berlin, CT

Design Associate

March 2005 to Present

The Garlinghouse Company

Glastonbury, CT

Design Director

1996 to 2002

Friendly Ice Cream Corporation

Wilbraham, MA

Architectural Design Supervisor

1994 to 1996

Friar Associates, Inc.

Farmington, CT

Interior Designer

1990 to 1991

Education:

Syracuse University

Syracuse, New York

Bachelor of Fine Arts: Interior Design

1990

Professional Affiliations:

U.S. Green Building Council

LEED Accredited Professional

2009

Resume

MICHELLE LANNEY

Architectural Renderer

Full-Time Employee 3 years

Professional Experience:

Jacunski Humes Architects, LLC

Berlin, CT

Project Architect

June 2012 to Present

Education:

Temple University, Tyler School of Art

Philadelphia, Pennsylvania

Bachelor of Architecture

May 2012

Public Safety Facility Cost Data

Preliminary Cost Estimates Vs. Actual Bids

Facility Cost Data	Cost Estimate	Bid Received	%	C.O. Total	Total Project
Rockland Police Department, MA	\$2,319,403.00	\$2,219,000.00	-4%	\$(92,076.41)	\$2,126,923.59
13,228 Square Feet (new)		(1998)		(-4%)	
Cost / Square Foot	\$175.00/sf	\$169.00/sf			
Granby Police Department, CT	\$1,855,000.00	\$1,835,044.00	-1%	\$22,060.00	\$1,857,104.00
8,900 Square Feet (new)		(1999)		(1.2%)	
Cost / Square Foot	\$208.00/sf	\$206.00/sf			
Stonington Police Department, CT	\$4,160,993.00	\$3,213,188.00	-23%	\$587,302.00	\$3,800,490.00
23,500 Square Feet (new)		(1999)		(18%)	
Cost / Square Foot	\$177.00/sf	\$171.00/sf			
Farmington Police Department/CSC, CT	\$7,639,243.00	\$7,900,000.00*	+3.5%	\$315,325.72	\$8,215,325.72
26,600 / 13,123 Square Feet (new)		(2000)		(4%)	
Cost / Square Foot - Police	\$192.31/sf	\$198.80/sf			
Wethersfield Police Department, CT	\$4,374,429.00	\$4,675,307.00*	+6.8%	\$106,246.52	\$4,781,553.52
25,675 Square Feet (new)		(2001)		(2.3%)	
Cost / Square Foot	\$170.40/sf	\$182.00/sf			
Canton Police Department, CT	\$1,731,703.00	\$1,729,000.00	0	\$(138,870.11)	\$1,590,129.89
8,506 Square Feet (new)		(2001)		(-8%)	
Cost / Square Foot	\$203.00/sf	\$203.00/sf			
East Hartford Public Safety Complex, CT	\$19,084,517.00	\$15,910,594.00	-16%	\$1,499,269.00	\$17,409,856.00
93,200 Square Feet (add/ren)		(2002)		(9.4%)	
Cost / Square Foot	\$205.00	\$187.00			
Newington Police Department, CT	\$5,973,380.00	\$5,917,149.00	-1%	\$226,163.00	\$6,248,613.00
24,741 Square Feet (new)		(2004)		(3.8%)	
Cost / Square Foot	\$241.00	\$237.00			
Acton Public Safety Facility, MA	\$4,482,490.00	\$4,995,292.00*	+10%	\$124,738.00	\$5,120,030.00
26,033 Square Feet (new)		(2003)		(2.5%)	
Cost / Square Foot	\$172.00	\$192.00			
Coventry Police Department, CT	\$1,733,404.00	\$1,458,900.00	-15%	\$23,327.00	\$1,482,227.00
6,680 Square Feet (new)		(2005)		(0.16%)	
Cost / Square Foot	\$259.00	\$218.00			
Dennis Police Department, MA	\$6,500,000.00	\$6,553,856.00*	+8%	\$306,116.30	\$6,859,990.30
23,000 Square Feet (new)		(2006)		(4.7%)	
Cost / Square Foot	\$240.00	\$242.34			
Danbury Police Department, CT	\$27,942,000	\$24,732,932.00	-11.5%	3,546,012.68	28,278,944.68
75,000 Square Feet (new) + 23,000 s.f. parking deck		(2007)		(14.34%)	
Cost / Square Foot	\$372.56	\$329.77			
Montague Public Safety Facility, MA	\$4,064,648	\$3,968,730.00	-2.4%	\$145,518.00	\$4,114,248.00
11,629 Square Feet (new)		(2008)		(3.66%)	
Cost / Square Foot	\$350.00	\$341.28			

Bolton Public Safety Facility, MA	\$4,656,507	\$4,311,394	-7.4%	496,914.89	\$4,808,308.89
16,630 Square Feet (add/reno)		(2008)		(10.67%)	
Cost / Square Foot	\$280.00	\$259.33			\$289.13
Marion Police Facility, MA	\$3,010,927	\$2,773,835	-7.9%	\$162,738.19	2,936,573.19
11,500 Square Feet (new)		(2009)		(5.4%)	
Cost / Square Foot	\$261.82	\$241.20			\$255.35
Chatham Police/Town Office Annex	12,671,293	\$12,775,596	+0.8%	\$166,437	\$12,942,033
18,412 Square Feet (police only)		(2009)		(0.13%)	
19,667 s.f. Annex, 2,250 s.f. outbuilding					
Cost / Square Foot	\$314.20	\$316.78			\$318.31
Darien Police Department, CT	\$15,075,000	\$13,850,426	-8.1%	\$896,968	\$14,747,394
37,000 Square Feet (add/reno)		(2010)		(6.5%)	
Cost / Square Foot	\$407.43	\$374.33			\$381.94
Monroe Police Department, CT	2,888,371	2,777,000	-3.9%	\$323,792	\$3,100,792
15,165 Square Feet (add/reno)		(2012)		(11.66%)	
Cost / Square Foot	\$190.46	\$183.11			\$204.47
Gardner Police Department, MA	\$9,500,000	\$9,780,360	+3%	In Constr.	
35,000 Square Feet (new)		(2013)			
Cost / Square Foot	\$271.43	\$279.44			
Westborough Fire Department, MA	\$8,723,000	\$8,253,000	-5.7%	In Constr.	
26,835 Square Feet (new)		(2013)			
Cost / Square Foot	\$325.00	\$307.55			
Norwell Police Facility	\$4,197,824	\$4,798,718	+14.3%	In Constr.	
12,202 Square Feet (new)		(2013)			
Cost / Square Foot	\$344.03	\$393.27			
Old Saybrook Police Department, CT	\$8,856,338	\$8,625,622	-2.6%	In Constr.	
22,624 s.f. (add / reno)		(2014)			
Cost / Square Foot	\$391.45	\$381.26			
Ledyard Police Department, CT	\$5,071,946	In Design			
12,380 Square Feet (new)		(2014)			
Cost / Square Foot	\$296.07				
Burlington Fire Substation	\$1,975,460	In Design			
6,422 Square Feet (new)		(2014)			
Cost / Square Foot	\$307.60				
Berlin Police Department, CT	\$15,237,074	In Design			
36,000 Square Feet (new)		(2014)			
Cost / Square Foot	\$423.25				
Bethel Police Department, CT	\$10,795,251	In Design			
26,647 Square Feet (new)		(2014)			
Cost / Square Foot	\$405.12				
AVERAGE				4.80%	

(add/ren) Indicates the project involved additions and renovations to an existing facility.

(new) Indicates the project is a new facility and costs include site work and contingency.

* Indicates that while the construction budget was exceeded, ample contingency was planned resulting in **no change to the overall project budget.**

Cost Estimates were executed at the completion of the Schematic Design Phase
Bids Received are the low bids accepted at the conclusion of the Bidding Phase

LEED / Sustainable Design Experience

Jacunski Humes Architects, LLC

Jacunski Humes Architects, LLC has four (4) LEED Accredited Professionals on staff.



LEED “SILVER” Certification:

Waterford Elementary Schools (3 total), Waterford, CT:

Great Neck, Oswegatchie, & Quaker Hill
Elementary Schools

New Canaan Ambulance Facility, New Canaan, CT

LEED Silver Certification by U.S. Green
Building Council



LEED Qualified / Sustainable Designs:

UCONN Public Safety Facility, Storrs, CT

Design to comply with State of CT, LEED Silver, and
High Performance Building Standards.

WCSU Police Headquarters, Danbury, CT

Design to comply with State of CT, LEED Silver, and
High Performance Building Standards.

Chatham Police and Town Offices Annex, Chatham, MA

Active chilled beam, 4-pipe mechanical systems
Daylighting sensors on lighting fixtures
Energy efficient pumps / motors.

Montague Public Safety, Montague, MA

Installed geothermal, closed loop mechanical systems with water to
air heat exchangers.

Darien Police Headquarters, Darien, CT

Designed for geothermal, closed loop mechanical systems with water to air heat exchangers.





GREEN BUILDING CERTIFICATION INSTITUTE

HEREBY CERTIFIES THAT

Brian Humes

HAS ACHIEVED THE DESIGNATION OF

LEED® ACCREDITED PROFESSIONAL

BY DEMONSTRATING THE KNOWLEDGE OF GREEN BUILDING PRACTICE
REQUIRED FOR SUCCESSFUL IMPLEMENTATION OF THE LEADERSHIP IN ENERGY
AND ENVIRONMENTAL DESIGN (LEED®) GREEN BUILDING RATING SYSTEM™.



Chairman

March 26, 2009

Date Issued

Peter Templeton, President



Sustainable Design

Kohler Ronan evaluates the environmental performance and impact of each and every project from a “whole building” perspective over a building’s life cycle. Our technical staff constantly challenges the standard that constitutes a Green Building by evaluating and collaborating with the design team on building orientation, envelope, fenestration, shading and indoor air quality to provide basis for determining appropriate systems for consideration.



SUSTAINABLE DESIGN

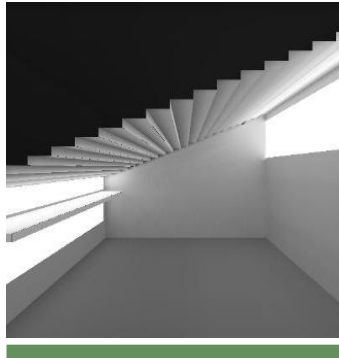

LEED "PERFECT CLASSROOM"

Depicts how the optimal usage of natural sunlight can create an environment conducive to learning.



JOHN DORR NATURE LAB, HORACE MANN SCHOOL

Skylights and windows reduce a facility's reliance on electricity, thereby effectively reducing operation costs.

Sustainable Design

Kohler Ronan is an active participant in both the sustainable and high performance design movements. Our involvement has enabled us to compile substantial knowledge of and experience working with programs & standards such as the 2030 Challenge, the Living Building Challenge, the Passive House Standard, ASHRAE's Building Energy Quotient Program, ASHRAE standards 90.1, 90.2, 189.1 (Standard for the Design of High-Performance Green Buildings) and the EPA's Energy Rating System.

Kohler Ronan recognizes the significance of sustainable practices in today's world. Regardless of whether or not a project is pursuing a LEED rating, our professionals evaluate the environmental performance and impact of each and every project from a "whole building" perspective over a building's life-cycle. Our technical staff constantly challenges the standard that constitutes a Green Building by evaluating and collaborating with the design team on building orientation, envelope, fenestration, shading and indoor air quality. Early in the design process, system alternatives are examined and evaluated against project goals in order to maximize affordable sustainability.

SUSTAINABLE DESIGN CAPABILITIES INCLUDE:

- Building Envelope and Orientation
- Fenestration and Shading
- Geothermal Heating and Cooling
- Low Water Consumption Fixtures
- Daylight Controls
- Energy Recovery
- Displacement Ventilation
- CO₂ Monitoring and Demand Control Ventilation
- Photovoltaic Electrical Generation
- Solar Thermal Hot Water
- Natural Ventilation
- Thermal Storage
- Rainwater Harvesting



**SUSTAINABLE
DESIGN**



Sustainable Design (continued)

Kohler Ronan takes pride in the design and delivery of engineering solutions that balance both environmental and financial considerations. By driving innovation, research and development, we test the boundaries of accepted best practices to develop improved solutions for the benefit of our clients. With that in mind, Kohler Ronan is aware of the risks associated with specifying novel technologies without giving ample consideration to maintenance requirements, product reliability, or impact on related building components. We also understand that even well-established technologies have little chance for success if they require more sophisticated operation and maintenance than building operators are capable of providing. While many industry professionals leave these problems to commissioning authorities or maintenance staff, the Firm is committed to confront these issues head on.

At Kohler Ronan we have the experience, foresight, and technical ability to develop strategies that not only perform up to specifications, but also perform consistently and reliably. We can call upon qualified staff from a range of disciplines and specialties to form an integrated approach that delivers tailored, proven solutions. We seek to deliver buildings that have a sustainable impact beyond the site boundaries by looking to integrate wider virtuous cycles into developments, where these are practically and economically achievable. This holistic approach allows us to see beyond the immediate development horizon and turn a potential challenge into a future asset.

Furthermore, each of our clients receives a comprehensive set of documentation including: Owner's Project Requirements (OPR); Basis of Design (BOD); and Operational Assumptions. These reports detail what equipment was installed, why it was installed, and operational strategies to achieve the overall performance/energy goals outlined during the design process. This package is supplemented with manufacturer manuals, reference sheets and part lists, contact and support information, in addition to Operations and Maintenance staff training.



**SUSTAINABLE
DESIGN**



Choate Rosemary Hall

PROJECT: Kohler Environmental Center

LOCATION: Wallingford, CT

ARCHITECT: Robert A.M. Stern Architects

OWNER: Choate Rosemary Hall

SIZE: 31,325 square feet

CONSTRUCTION COST: \$20 million

COMPLETION DATE: 2012

Choate Rosemary Hall is the result of the 1971 merger of the Choate School and Rosemary Hall. The institution is ranked among the top secondary schools in the country. Situated on 458 acres, the campus has 121 buildings including the Paul Mellon Arts Center and the Carl C. Icahn Center for Science, both of which were designed by renowned Architect I.M. Pei.

Choate Rosemary Hall embarked on a plan to create an innovative environmental center on over 260 acres of property adjacent to its existing campus. Made possible by a generous gift of Herbert V. Kohler, Jr. (class of 1957) president and chairman of Kohler Company, the new center combines interdisciplinary academics with a residential program focused on environmental science. Designs incorporate 14 dormitories, dining facilities, seminar rooms, laboratories, faculty/staff housing and a state-of-the-art greenhouse.

Kohler Ronan is delighted to have designed the sophisticated MEP/FP systems for this unique facility. Sustainable elements are integral to the project since one of the goals

was to achieve a LEED Platinum certification for the building. Other goals included achieving net-zero energy usage. Nearly 100% of the energy needs are provided by a photovoltaic array and roof mounted thermal solar panels.

To help achieve such ambitious goals, Kohler Ronan conducted several energy simulations using advanced modeling software. We were able to determine the building's best performance based on innumerable variables like orientation, window and door placement, insulation, type of equipment, daylighting and natural ventilation. Today, students are able to track this performance via specialized dashboard monitoring systems.



**SUSTAINABLE
DESIGN**



John Dorr Nature Laboratory

PROJECT: Nature Laboratory at Horace Mann School

LOCATION: Washington, CT

ARCHITECT: Centerbrook Architects and Planners

OWNER: Horace Mann School

SIZE: 19,000 square feet

CONSTRUCTION COST: \$8 million

COMPLETION DATE: 2009

After several moves and mergers, the Horace Mann School settled into its primary campus in Riverdale, NY. Well known for its academic programs, the school is perhaps equally well known for its pioneering outdoor education and environmental center. The John Dorr Nature Lab was formed following a 1964 gift of 85 acres of woods, fields and streams in Northwest CT.

Almost all of the initial work in preparing the building site for the John Dorr Nature Lab was done by the students of Horace Mann School. They split wood, cleared trails and stream beds, and built shelters. The original lodge had no plumbing or shower, only an outhouse accommodating eight. The lab was then, and is now, an exemplification of the school's belief that educational institutions should provide experiences both inside and outside the traditional classroom.

All students of the school visit this 275-acre outdoor campus as part of the academic curriculum. In this living laboratory, an awareness, understanding and appreciation of the earth and its environment are instilled. Given this outlook, it is no surprise that when it came time for a new lodge and bunk

house on the John Dorr campus, the school was very concerned with sustainability.

Kohler Ronan's extensive Sustainable Design experience was applied throughout the design process for this project. Our team devised new HVAC, Electrical, Plumbing and Fire Protection (MEP/FP) systems with the idea that all sustainable elements would be an integral part of the learning environment. Rainwater harvesting, photovoltaic electrical generation, solar water heating, water conservation, and radiant floor warming systems were designed to be easily studied on student visits.

*Recipient of the 2011 Merit Award from
Connecticut Chapter of the USGBC.*



**SUSTAINABLE
DESIGN**



Greenberg Conference Center

PROJECT: University Conference Facility
LOCATION: New Haven, CT
ARCHITECT: Robert A.M. Stern Architects
OWNER: Yale University
SIZE: 13,000 square feet
CONSTRUCTION COST: \$15 million
COMPLETION DATE: 2010

In 1701, Yale was founded in Saybrook, Connecticut. Operating from the home of its first rector Abraham Pierson, the school's mission was to educate students for "Publick employment both in Church & Civil State." The school moved to New Haven in 1716. Having steadily expanded its academic disciplines, in 1887 the institution became Yale University.

Yale University has in recent years expanded its mission to include programs for international executive education. These programs are geared, in large part, toward senior government officials, university presidents and their teams, and the leaders of state-owned businesses from China and elsewhere. Thanks to support from the Maurice R. Greenberg Yale-China Initiative, a new conference center was conceived to host these dignitaries.

Kohler Ronan was enlisted to provide professional services for this facility. The project's scope included several sustainable design features: energy modeling for

building position and envelope options, geothermal heating and cooling via a ground coupled standing column well, displacement HVAC, and demand controlled ventilation with CO₂ monitoring.

The displacement ventilation was designed below the floor in the amphitheater and in the walls for the dining areas to optimize occupancy comfort. Energy savings were achieved across the board and may be monitored via the measurement and verification system designed to track consumption and systems performance.

