

From: [Rep. Michel, David](#)
To: [Berns, Philip](#); [Nabel, Susan](#); [Rosenson, Valerie](#)
Cc: [Board of Representatives](#); [Sherwood, Nina](#); [Curtis, Jeff](#)
Subject: Testimony in regards to the proposed sale of the Glenbrook Community Center
Date: Tuesday, August 23, 2022 10:51:49 AM

Dear esteemed chairs of the Legislative and Rules Committee, Representatives Nabel and Berns, and esteemed members of the committee,

I hope this email finds everyone well.

I am testifying against the sale of the Glenbrook Community Center, that is the item tonight.

We are far from having community centers in each of Stamford's neighborhoods. Community centers are places where your children will learn how to do martial arts, sports, theater, arts and crafts and so much more. It is a place where families can come and talk about issues or come and resolve their problems.

I know many who are my age and yet recall many activities they are thankful for at their community centers, in particular the Glenbrook one.

We need more "affordable" housing and we need more "affordable housing". That is quite clear. However I cannot imagine that the 51 affordable housing units will actually be affordable to the most in need of it. In order to be able to afford the smallest studio, they'd still have to make somewhere about 70% more than the current minimum wage.

This reminds me of the pretense Desegregate approached us with those remarks, yet the Transit Oriented Development plans brought to us at the state do not help those most in need, and they continuously insult us with terms such as "as of right" which means without public process. As legislators it is clear we represent the public so I do not know what kind of legislator they are trying to reach with language killing any public process. But that is another story, I just think it is strangely similar to their use of the word affordable, pretending to help those in need, and yet when doing the maths, we are not there.

I will also say that zoning residential lots that are close to polluting facilities is not the answer. Our land use really messed up by doing this by canal and dock. You cannot build an asphalt batch plant within 0.3 miles of residential so what makes Land Use think it is ok to zone residential 0.15 miles from an asphalt batch plant?

I assure you all, disagreements in regards to where to build housing, are there to do with our role to represent the public, versus developers, and at times, public health. Let us fix "affordable" and bring more housing for those in need, but where it makes sense.

The Glenbrook Community Center has served a great purpose, and should continue to do so. I cannot accept the manipulation around this subject, that convinced some of the community this building had to be sold to become affordable housing, that is not truly affordable to those this is pretending to help.

We should work together, residents, municipal and state officials, in transparency and with practical sense while respecting the neighborhoods and Public Health, Social and Environmental Justice, for healthy neighborhoods.

Please do what you can to preserve the Glenbrook Community Center.

Kind regards,

David

State Representative David Michel

(+1-914-843-7545

Proudly representing Downtown, Shippan, and the South End

Assistant to the Majority Leader

Co Chair of the CT Animal Advocacy Caucus

Member & Proponent of the CT Offshore Wind Commission for Environmental Standards

Member of the Environment, Planning & Development, and Transportation Committees

p.s. Ms Rosenson, may you please make sure it is sent to all members of the committee as soon as possible? thank you!

From: [mj gluck](#)
To: [Board of Representatives](#)
Subject: Fwd: Message from WeedBranchScanner
Date: Tuesday, August 23, 2022 3:42:53 PM
Attachments: [SWeedBranch22082313520.pdf](#)

paraphrasing a resident

"The main damage is giving approval to a lower income housing development to be built next to an environmentally damaging usage. It seems that the building is adjacent to it, abutting. Remove this environmentally damage usage first before approving putting lower income people next to it. It appears to be a good opportunity to force the damaging usage out of our primarily residential neighborhood."

from melissa gluck

----- Forwarded message -----

From: <patronscanferg@fergusonlibrary.org>
Date: Tue, Aug 23, 2022 at 12:58 PM
Subject: Message from WeedBranchScanner
To: <mjgluckemt@gmail.com>

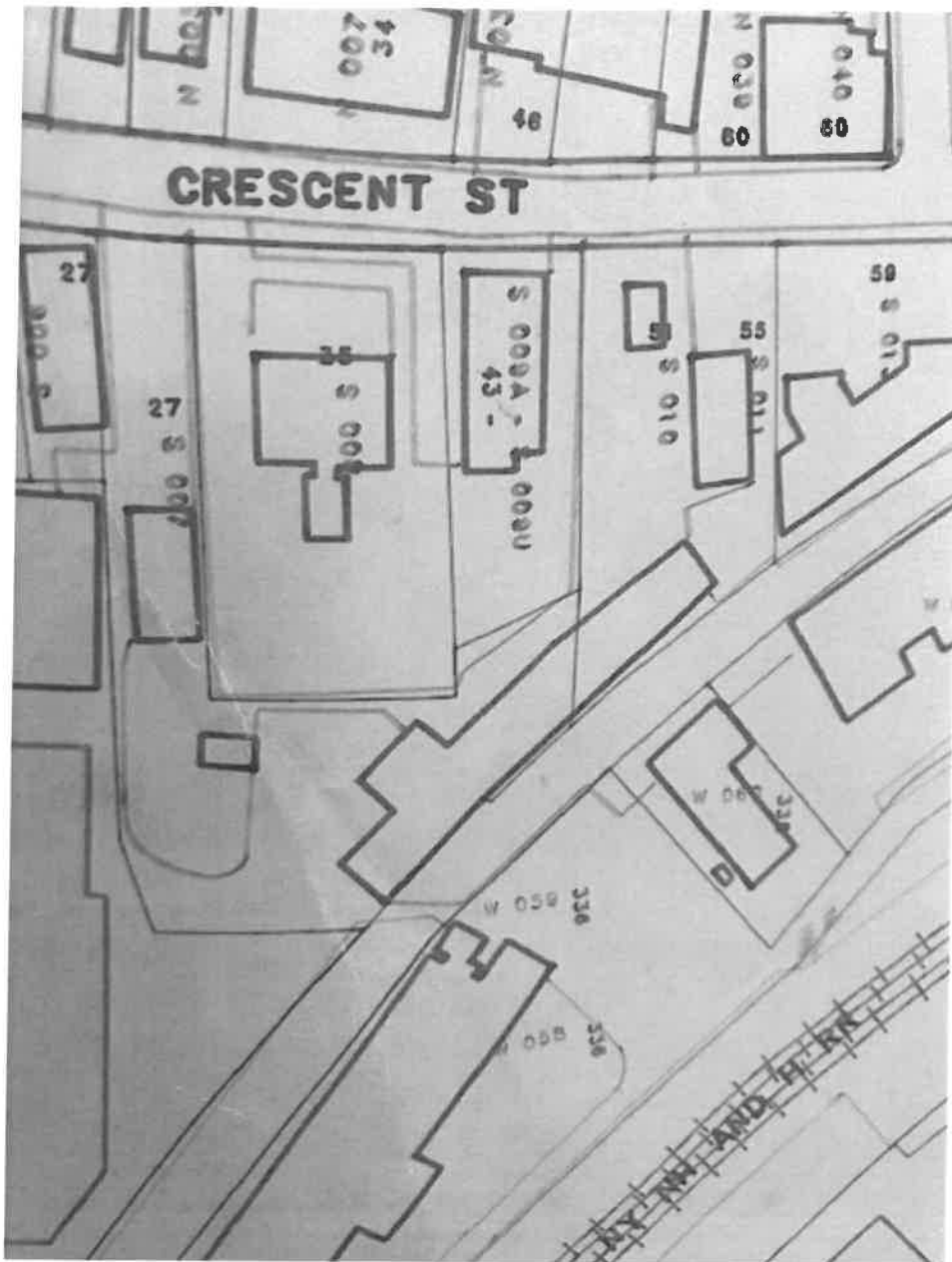

Glenbrook School building
 35 Crescent St.

environmental safety
 concern
 with building behind it
 process

msgluckent
 @g mail.com

Rosenson, Valerie

From: Laurie Doig <doig62@yahoo.com>
Sent: Tuesday, August 23, 2022 4:24 PM
To: Rosenson, Valerie
Subject: Fwd: NEW INFORMATION regarding tonight's public hearing



Dear GNA Member,

The GNA Board received information yesterday that there are two new proposals that have surfaced that would retain 35 Crescent Street as a community center. Based on this new information, the majority of the Board has decided to withhold its support for the current proposal to repurpose 35 Crescent Street for mixed-income affordable housing.

The Board hopes to be able to provide the Glenbrook community with further information as soon as possible.

Best regards,

The GNA Board

Glenbrook Neighborhood
Association | Glenbrookassn.com

